

# Exhaust air valve OPK-M-series

OPK-M-series, exhaust motorized air valve,  
100 mm - 160 mm



# Exhaust air valve OPK-M-series

OPK-M-series, exhaust motorized air valve, 100 mm - 160 mm



OPK-M is an electric motor-controlled air valve for use in central air systems for ventilating rooms where you want to force ventilation, eg in bathrooms, kitchens, basement rooms etc. The valve opens electrically which will increase the air flow by a factor of 2-6 times. After the electricity is switched off, the valve automatically returns to its basic position (basic air volume mode). The design of the valve and a gasket of moltoprene prevents soiling. All components are designed for use in harsh environments and are not affected by, for example, moisture or dust

## Attachment, adjustment and detachment

The valve is pushed into the frame. The cone is screwed out or in the number of turns giving the gap an opening in mm corresponding to pressure drop and the desired air flow according to the diagram. The pressure drop can be checked by using a suitable measuring device. When dismantling, the valve is pushed sideways and then pulled out.

## Material

The valve is made of polypropylene plastic that can withstand temperatures up to 120 degrees

Celsius. The material keeps its color over time and is recyclable. The motor housing is produced in galvanized steel.

## Cleaning

The valve is cleaned with normal detergent.

## Color

Standard white (RAL 9003). Other colors can be delivered by arrangement.

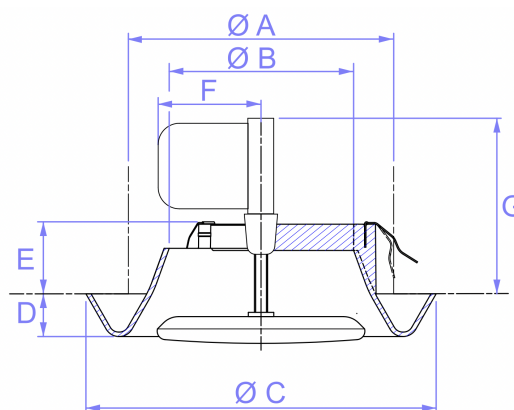

OPK-M	Ø A	Ø B	Ø C	D	E	F	G	Weight
100-M	100	80	152	20	31	50	115	345 gr
125-M	125	98	165	23	30	50	120	370 gr
160-M	160	115	190	20	35	50	120	465 gr



# Specifications

## Capacity charts

### Voltage

240v, 50-60 Hz.

### OPK 100M

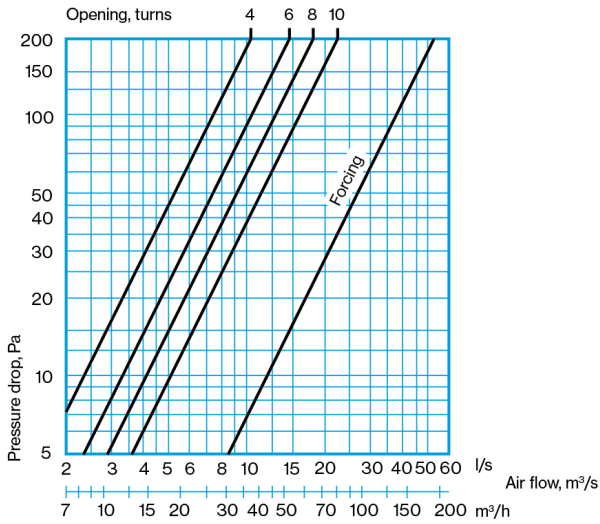

### OPK 125M

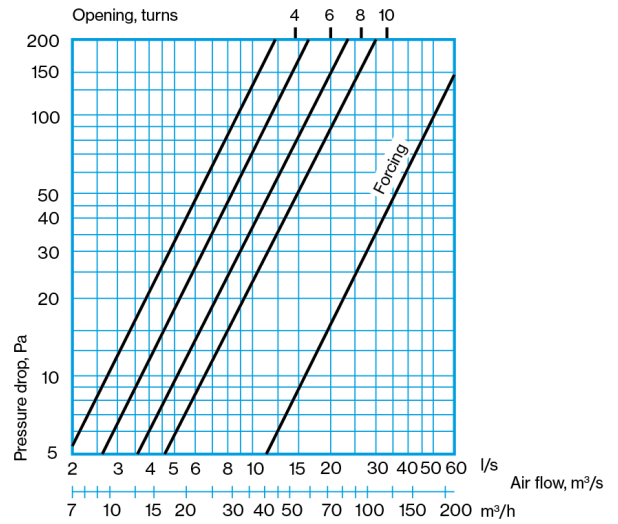

### OPK 150M

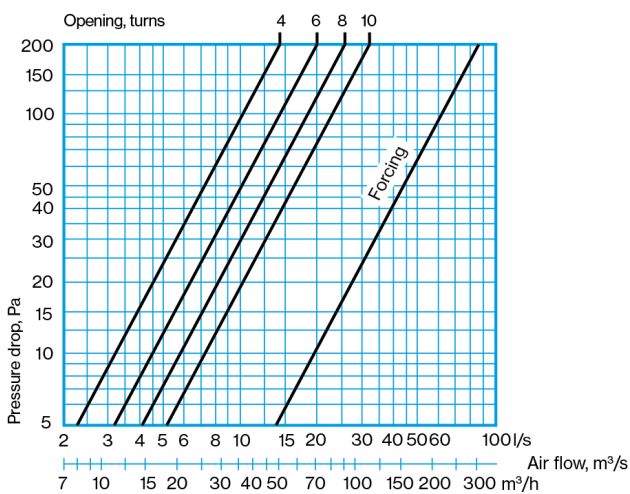

### OPK 160M

